



# GORDIE HOWE INTERNATIONAL BRIDGE UPDATED: I-75 NORTHBOUND AND I-75 SOUTHBOUND CLOSURES

Bridging North America will temporarily close several ramps and streets, including lanes on northbound I-75 and southbound I-75. This closure is required to support construction work for the Springwells Street, Livernois Avenue and Clark Street bridges.

### Northbound I-75 Daily/Long-Term Closures

- Three right lanes will close on northbound I-75 from Harbaugh Street to Clark Street on March 5 – 6, 2021.
- Three left lanes will close on northbound I-75 from Harbaugh Street to Clark Street on March 6 – 7, 2021.
- The left lane will close on northbound I-75 between Harbaugh Street and Clark Street from March 7 – January 31, 2022.

### Southbound I-75 Daily/Long-Term Closures

- Three right lanes will close from Lansing Street to Springwells Street from March 12 - 13, 2021.
- All lanes of the Clark on-ramp at southbound I-75 will be closed from March 12 - 13, 2021.
- Three left lanes will close on Southbound I-75 from Lansing Street to Springwells Street from March 13 - 14, 2021.
- The right lane of southbound I-75 will close between Bagley Avenue and McKinstry Street from March 14 - June 30, 2021.
- The left lane of southbound I-75 will close between Springwells Street and McKinstry Street from March 14, 2021, to January 31, 2022.
- The Vernor Highway on-ramp to southbound I-75 will be closed from March 14 - July 7, 2021.

I-75 Northbound & Southbound Temporary Closures

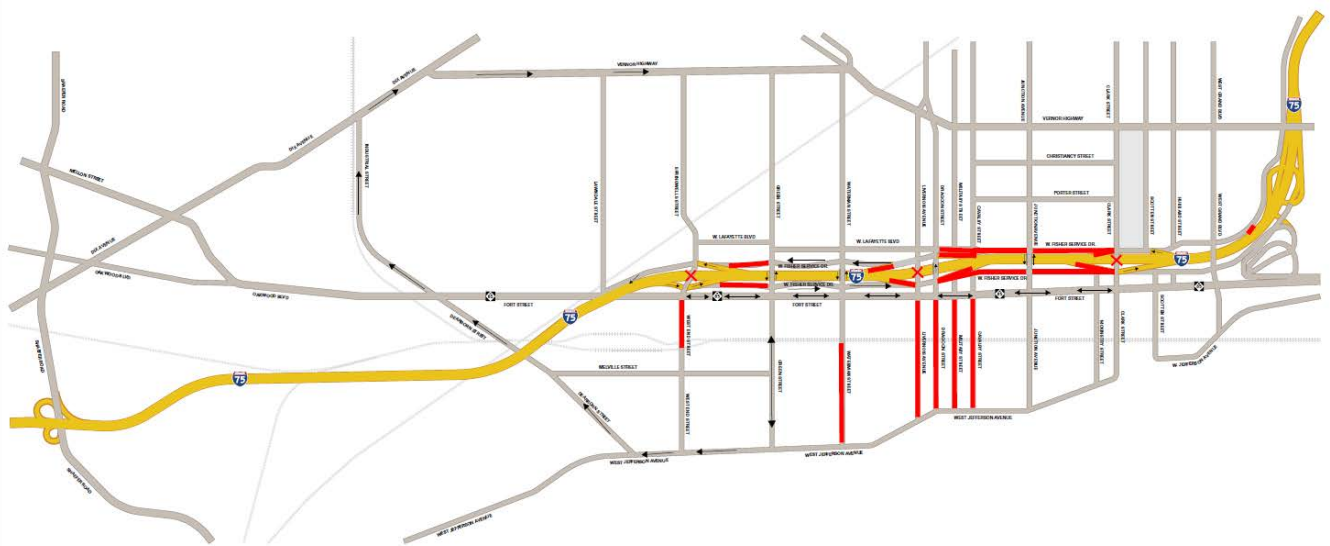

We appreciate your cooperation throughout this project. Every effort will be made to reduce inconvenience to drivers, residents and the business community. If you have any questions or concerns regarding traffic or these construction activities find out more:

### FIND OUT MORE:

Visit: [www.GordieHoweInternationalBridge.com](http://www.GordieHoweInternationalBridge.com) Email: [info@wdbridge.com](mailto:info@wdbridge.com)

Call: 1-844-322-1773

Follow us on social media:

